

## HOW TO USE BD™ ESwab™

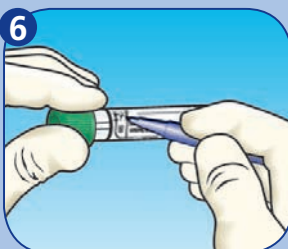

## COLLECTION AND TRANSPORT GUIDE

BD™ ESwab™ can be used for all aerobic, anaerobic and fastidious bacteria collection needs.

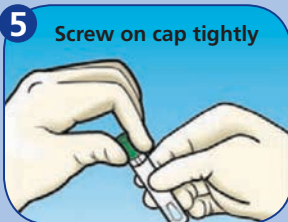
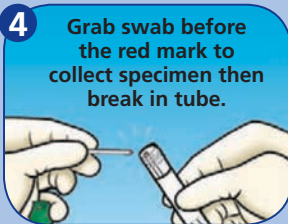
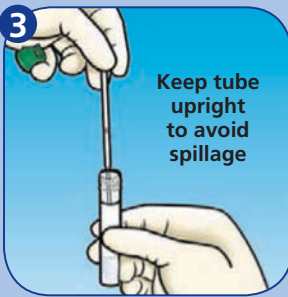
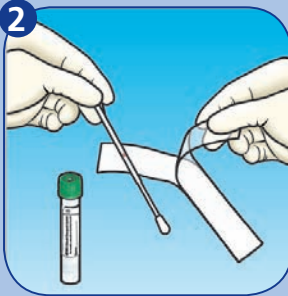
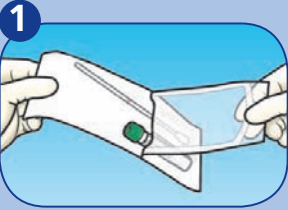

### 220245 - BD™ ESwab™ Regular Collection Kit

White cap w/Liquid Amies and a regular flocked swab

For nose, throat, vaginal and wound specimens

**NOT for tissue specimens or body fluids.  
SUBMIT TISSUE SPECIMENS AND BODY FLUIDS  
IN A CLEAN STERILE CONTAINER.**



### 220246 - BD™ ESwab™ Minitip Collection Kit

Green cap w/Liquid Amies and a minitip flocked swab

For eye, ear, nasal passages,  
nasopharynx and urogenital tract

### 220245 BD™ ESwab™ Regular Collection Kit and 220246 - BD™ ESwab™ Minitip Collection Kit REPLACE



220117 — Amies Gel w/o Charcoal, Double Swab



220145 — BD BBL™ CultureSwab™ EZ II



The uses above are based on institutional procedures. See product package insert for manufacturer's recommendations.

**BD Diagnostics**  
7 Loveton Circle  
Sparks, MD 21152-0999  
800.675.0908  
www.bd.com/ds

Eswab is a trademark of Copan Italia S.P.A.  
BD and BD Logo are trademarks of Becton, Dickinson and Company. ©2015 BD